



**Suprajit
Engineering
Limited**

Registered & Corporate Office : #100 & 101, Bommasandra Industrial Area,
Bengaluru - 560 099. Tel: +91-80-43421100, Fax: +91-80-27833279
E-mail: info@suprajit.com Web : http://www.suprajit.com
Corporate Identity Number (CIN) : L29199KA1985PLC006934



April 6, 2022

**Ref: 532509
BSE Limited
Department of Corporate Services
P. J. Towers, 25th Floor, Dalal Street,
Mumbai- 400 001**

**Ref: SUPRAJIT
National Stock Exchange of India Ltd
Exchange Plaza, C-1, Block-G,
Bandra Kurla Complex, Bandra (E)
Mumbai- 400 051**

Dear Sir/ Madam,

Sub: Press Release - Suprajit Engineering Limited ("Suprajit") concludes the acquisition of Light Duty Cable (LDC) business unit of Kongsberg Automotive ASA.

Enclosed please find Press Release dated April 6, 2022 regarding "conclusion of acquisition of Light Duty Cable (LDC) business unit of Kongsberg Automotive ASA by Suprajit Engineering Limited ("Suprajit")" along with an "Investor presentation".

This is for your Information and records.

Please consider this as compliance under Regulation 30 of SEBI (Listing Obligations and Disclosure Requirements) Regulations, 2015.

Request you to take the same on record.

Thanking you,

Yours faithfully,
For Suprajit Engineering Limited,

**Medappa Gowda J
CFO & Company Secretary**



Encl: as above

PRESS RELEASE

April 6th, 2022

SUPRAJIT ENGINEERING LIMITED (SUPRAJIT) CONCLUDES THE ACQUISITION OF LIGHT DUTY CABLE (LDC) BUSINESS UNIT OF KONGSBERG AUTOMOTIVE ASA.

Suprajit is pleased to announce that it has successfully concluded the acquisition of Light Duty Cable (LDC) business unit from Kongsberg Automotive ASA ('Kongsberg Automotive'). The LDC business unit of Kongsberg Automotive, supplying to automotive, non-automotive and 2-wheeler segments along with Electro-Mechanical Actuators (EMA) is now part of Suprajit Group. All the four LDC related entities are now 100% owned stepdown subsidiaries of Suprajit through Suprajit USA, Inc.

LDC consists of three manufacturing plants located at Matamoros – Mexico, Siofok – Hungary and Shanghai – China. It has a Tech Centre at Novi, Detroit (USA) and a distribution centre in Brownsville (USA). The transaction also involves the transfer of global sales and engineering expertise related to the LDC business located in US, Germany, France, , Sweden, and the UK, to Suprajit.

The total employee strength of LDC is around 1300. The sales for the calendar year 2021 was US\$ 85 million with operating EBITDA margin of about 8%. The Enterprise Value (EV) of the transaction is US\$ 42 million. Suprajit expects the business to exceed US\$ 100 million in the next couple of years with double digit EBITDA.

Suprajit has used a portion of cash available with the Company and balance through debt to complete this transaction, leaving behind a significant cash surplus with the Company.

LDC has marquee global customers in the automotive, non-automotive and 2-wheeler businesses including Tesla, Fiat, Land Rover, Mercedes, Honda, STIHL, Shiroki, Adient, Husqvarna, Lear, Magna, etc. Suprajit's annual global cable capacity will now exceed 400 million. Suprajit will also emerge as a global leader in the control cable business with a strong global footprint to serve any customer in all of these segments. LDC has a complimentary manufacturing footprint, customer base, product and technology.

Suprajit will also acquire the actuation technology through this transaction, making Electro-Magnetic Actuators (EMA), a new product segment for the group. This acquisition will bring much needed focus to the cable business for the LDC division. Suprajit is confident to grow this business profitably, complementing the strengths of both LDC and Suprajit.

Ajith Rai, Founder and Chairman of Suprajit, said – *“We heartily welcome all the employees of LDC to Suprajit Family on the conclusion of acquisition of LDC. It is heartening that Suprajit will emerge not only as a global leader in mechanical control cable systems but will aspire to become most preferred supplier in the world. Our combined manufacturing footprint in India, China, Hungary, USA and Mexico, with engineering centres in Novi (USA), Wichita (USA), Tamworth (UK) and Bangalore (India), along with the engineering support in multiple countries, will give Suprajit group a deep-rooted presence in this business. With 400 million annual cable capacity, Suprajit will have the capability to emerge as a ‘one-stop shop for cables’ in the world. We are excited about the opportunities, this acquisition will bring to Suprajit.”*

Mohan N S, Managing Director and Group CEO, said – *“Our strategy of **Cables beyond India and in India beyond cables** has been pursued with a clear focus. With this acquisition, we have demonstrated our ability to scale up to world class levels. We have also expanded our management bandwidth to manage plants in various geographies to serve our customers across the globe and truly become a global player”.*

Akhilesh Rai, Director and Chief Strategy Officer, said – *“LDC will form the fulcrum of a global Suprajit. Our strong push into systems through Suprajit Tech Center, along with our access to global customers and global platforms, will be a transformative acquisition for Suprajit as we move to support our customers in a holistic manner, from cables today to actuation technologies tomorrow.”*

Jim Ryan, President, Suprajit USA, said *“I am happy to welcome the team at LDC into the Suprajit family and I look forward to the work ahead of us to ensure that the combined value of the companies, for all stakeholders, is greater than just the sum of the two individual parts.”*

Grant Thornton Bharat LLP, India are the sole financial advisors and Oppenhoff & Partner, Germany, are the lead legal advisors to Suprajit for this transaction.

About Suprajit Engineering Limited:

Suprajit is one of the largest mechanical cable and halogen bulb manufacturers in the world with an annual global capacity of 400 million cables and 110 million halogen bulbs. Suprajit’s customers list includes many marquee global majors.

For further information, please contact:

Mr.Medappa Gowda J Chief Financial Officer& Company Secretary Suprajit Engineering Limited Email: medappagowdaj@suprajit.com	Mrs. Bhargavi Aithal AGM - Corporate Communications Suprajit Engineering Limited Email: bhargavi@suprajit.com
---	--

For Suprajit Engineering Limited,

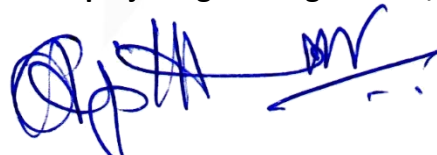

**K. Ajith Kumar Rai,
Chairman.**

**Suprajit Successfully Completes
Acquisition of Light Duty Cable (LDC)
Business Unit of Kongsberg Automotive**

Date: April 6, 2022

**Enabling
A World
In Motion**

- › **Suprajit Engineering Ltd has completed the acquisition of all the legal entities and assets of Kongsberg Automotive's Light Duty Cables (LDC) business unit**
- › **LDC is transformative for Suprajit**
 - › **Expected to add \$100 Mil+ in revenue with double digit EBITDA in the next two years.**
 - › **Strategically located in Mexico, USA, Hungary and China**
 - › **Significantly expands Suprajit's automotive footprint in Americas and Europe while further improving our position as the leader in Non-Automotive and Off-Highway controls in both Geographies.**
 - › **LDC's Shanghai Lonestar plant is a reputed cable business in China and will allow Suprajit to offer a new key manufacturing location to our customers**
 - › **LDC's Electro-mechanical Actuators will become new product segment to Suprajit**
- › **Jim Ryan, President Global Operations will lead the acquired entities in addition to his current responsibilities at Wescon Controls LLC (USA) and Suprajit Europe Ltd.**
- › **The current installed capacity of LDC division is 106 Million cables per annum. With this acquisition the group's cable installed capacity will increase to 400+ Million cables per year.**
- › **The enterprise value of this transaction is 42.00 Million USD which will be subject to standard closing review adjustments**

An aerial photograph of a road with white lane markings, flanked by trees with vibrant yellow and orange autumn foliage. A blue banner with a white arrow shape is overlaid on the left side of the image.

LDC as Part of Suprajit



	Cable Manufacturing Facilities					Capacity
	China	Hungary/UK/Europe	India	Mexico	USA	Global
Suprajit	No	Warehousing	PV + OFH	OFH	OFH	300
LDC	PV + OFH +2W	PV + OFH	No	PV + OFH	No	106
Suprajit with LDC	PV + OFH+2W	PV + OFH	PV + OFH	PV + OFH	OFH	406

PV – Passenger Vehicle (Automotive)

OFH – Off Highway (Agriculture, Outdoor Power Equipment, etc)

2W – Motorcycles (2-Wheelers)

■ 2 Wheeler ■ Aftermarket ■ Automotive ■ Non-automotive

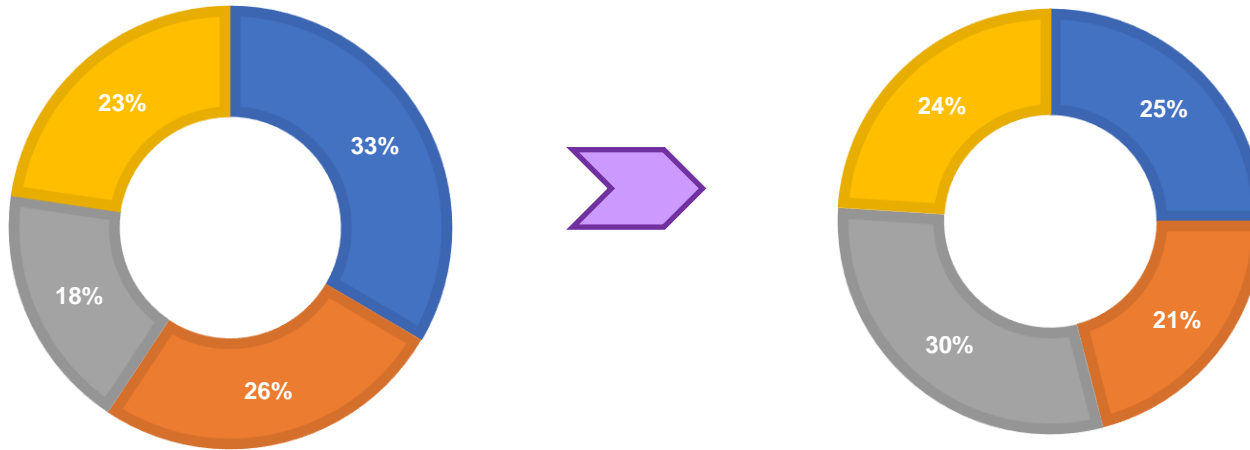

LDC's Automotive Exposure improves Suprajit's diversification and reduces Two Wheeler Exposure to 25%

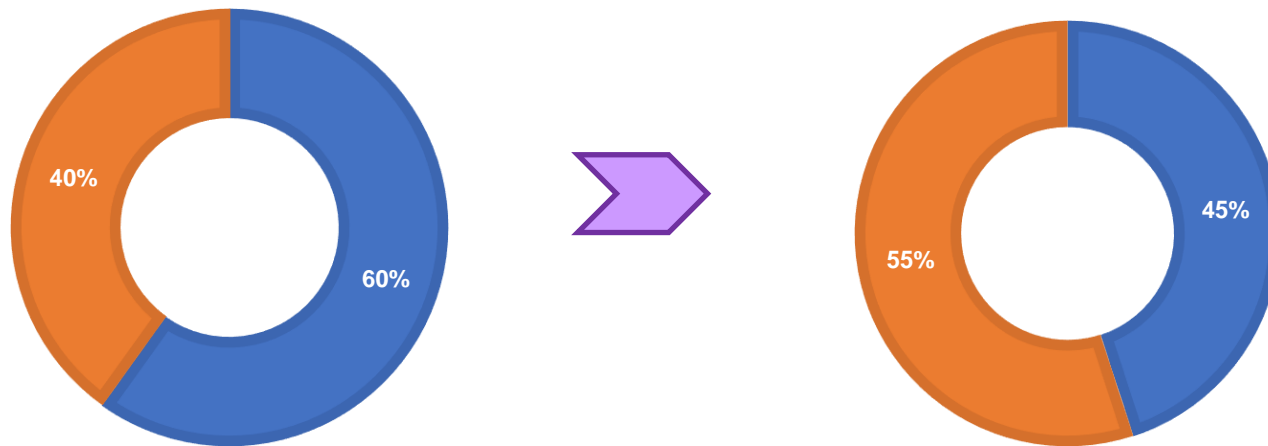

Transformational Acquisition that makes Suprajit a truly Global Automotive Ancillary with further de-risked revenue streams

■ India ■ Global

Before LDC: Technology Centers of Suprajit

- USA – Supports OFH
- UK – Supports Automotive
- India – Supports All Verticals

Technology Centers with LDC

- USA – Supports PV & OFH
- UK – Supports PV & OFH
- Germany- Supports PV & OFH
- China – Supports All Verticals
- India – Supports All Verticals

LDC brings Strong Customer Connect

- Suprajit's Core Cable Engineering to a Customers' Doorstep
- Possible introduction of new products from STC



Push/Pull/Push-Pull Control Cables

Allied Motion Control Parts



Friction Products



Electronic Throttle Control



Combi-Brake Systems



LDC: Motor Actuation (EMA)



Halogen Lamps

Vehicle Lighting



LED Retrofit High Power



LED Retrofit Eco



Analog Speedometer

Instrument Clusters



Semi-Digital Cluster



Digital & EV Clusters



Flexible Shaft

Control Cable Mechanisms

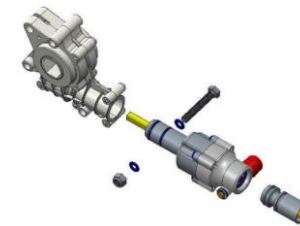

Seeder Gearbox + Cable Assemblies



Lever + Cable Assemblies



Valve Controllers



LDC: Mechatronic Control Mechanisms

LDC brings premiumisation focused Technologies that are nascent in India

LDC's Select customers



“Perfect Match” of Customer Bases

- LDC has been a respected global leader in the cable business
- Global leadership position has led to a diversified global customer base just like Suprajit (in India)
- Since Suprajit and LDC have had different focuses within the cable segment, there is very little overlap in customers/platforms
- LDC is on various global EV platforms including Tesla
- Strong Relationships with Customer's Engineering Teams will help Suprajit bring more engineered solutions to the table

Suprajit Group with LDC will have no single customer exposure greater than 10%

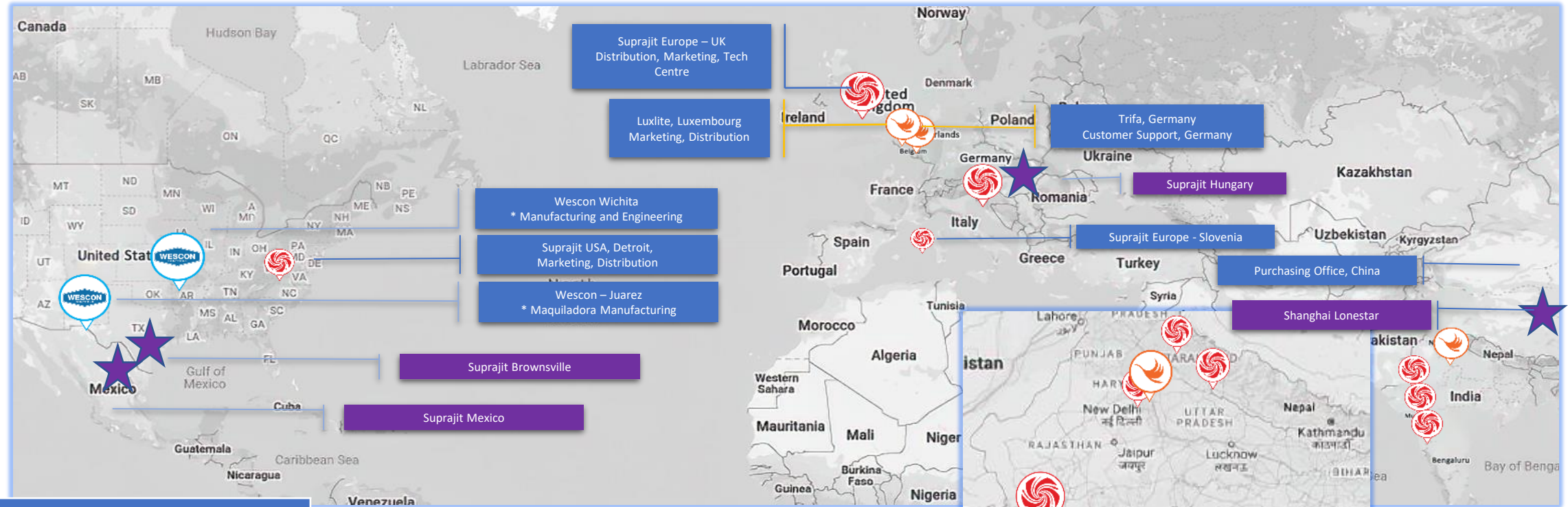

Manufacturing Plants

India	18
US	1
Mexico	1

LDC Plants

Mexico	1
Hungary	1
China	1
US	Warehouse



Phoenix:

- Noida 2 Plants, SEZ & DTA
- Chennai – 1 Plant



Suprajit – India:

- Headquarters,
- Global Manufacturing Hub
- 15 Strategically located plants

LDC also has Strong Sales and Engineering teams in Novi (Detroit USA), Burton (UK), Munich (Germany), and at each plant location (Mexico, Hungary, China)

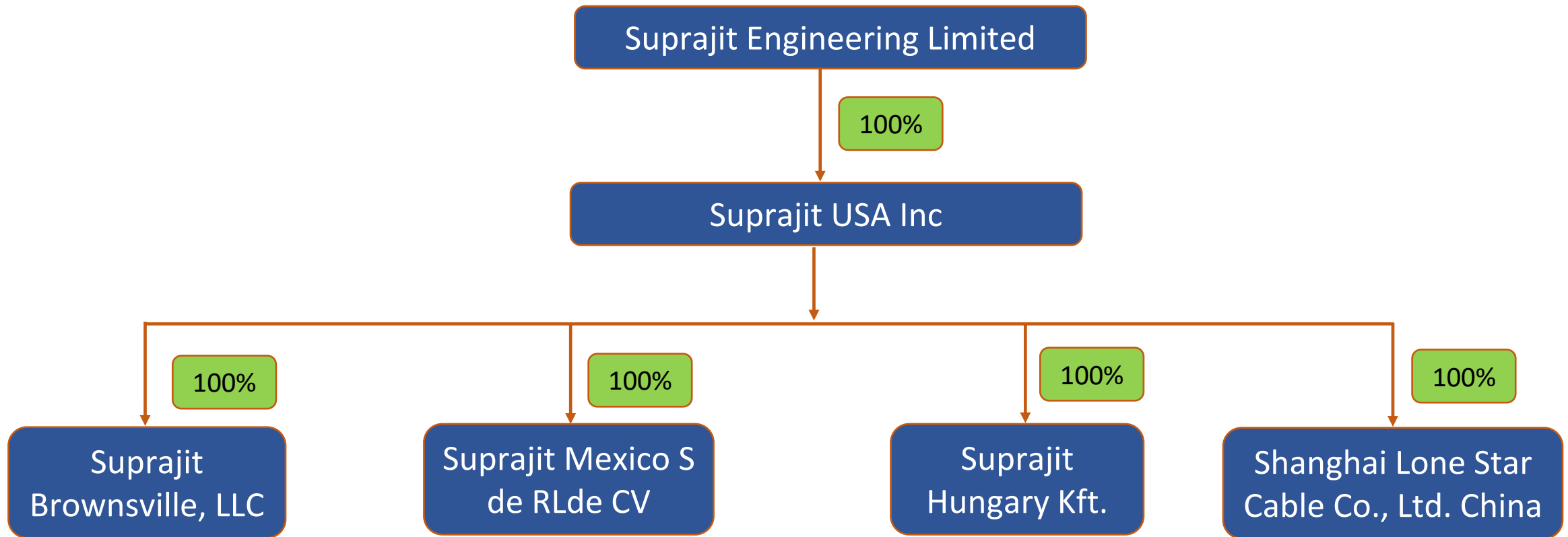

Suprajit Engineering Limited

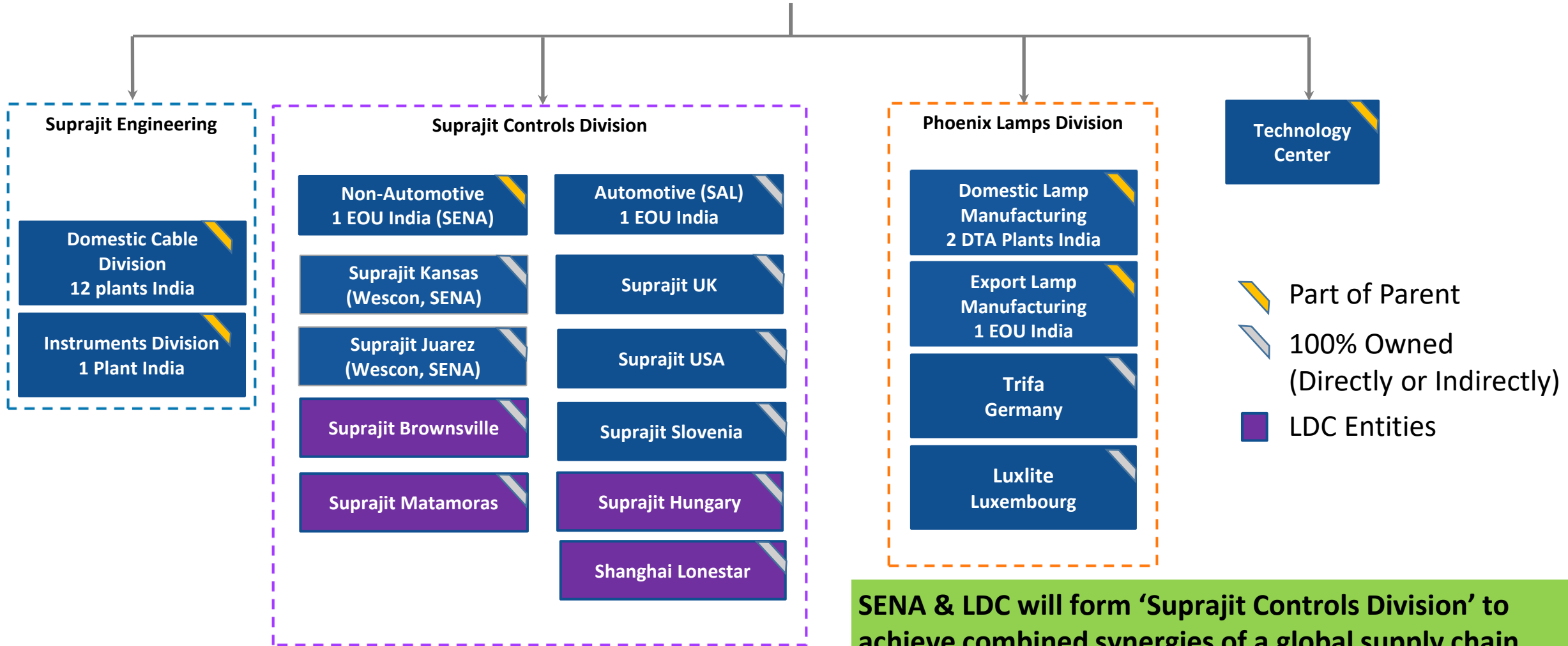

SENA & LDC will form 'Suprajit Controls Division' to achieve combined synergies of a global supply chain, and strong local engineering and sales teams

Thank You